



The Programme

Contents

Page

2	Getting here
3	Site plans
6	The Organisers
7	The Reception Team
	Breakfast and other meals
8	IT & Electrics
	Fire
	Health & Safety
	Disabled visitors
	Smoking
	Insurance
9	Presentation schedule
11	Test Lab
12	Schedule for the visits programme, coach times, return times, etc.
13	Delegate list by call sign
17	Delegate list by surname

Getting here

Click [here](#) to download a pdf file with all the travel information on the EME2012 site, including weblinks.

Bus services to Cambridge from the major airports

Stansted STN

National Express 727/797, every two hours

Luton LTN

National Express Service 787 to Cambridge, 10 times a day

Heathrow LHR

National Express Service 787 via Luton Airport

National Express Service 727 to Stansted Airport and change
LHR bus & coach map is [here](#)

Gatwick LGW

Bus not recommended. Use the [Gatwick Express](#) train service to London.

The last mile/km

We recommend entry via Madingley Road along Storey's Way to avoid narrow access via the longer Huntingdon Road - Storey's Way route.

See [Open Streetmap](#)

The car park is at the end of Churchill Road beyond Sheppard Flats. There is also parking along Churchill Road.

A detailed plan of the site can be downloaded from [here](#).

If you are arriving by train or by coach from Stansted airport, we suggest you take a short taxi ride to the college.

There is a taxi rank opposite the train station entrance with a plentiful supply of taxis, so no need to book.

The central bus station is strung out along Drummer Street, Parker Street and Parkside.

There is a taxi rank on St. Andrew's Street opposite Lion Yard, and possibly also on Parkside.

If people arrive by bus and can't find a taxi the best company to call would be Panther Taxis - 01223 715 715

Site Plans

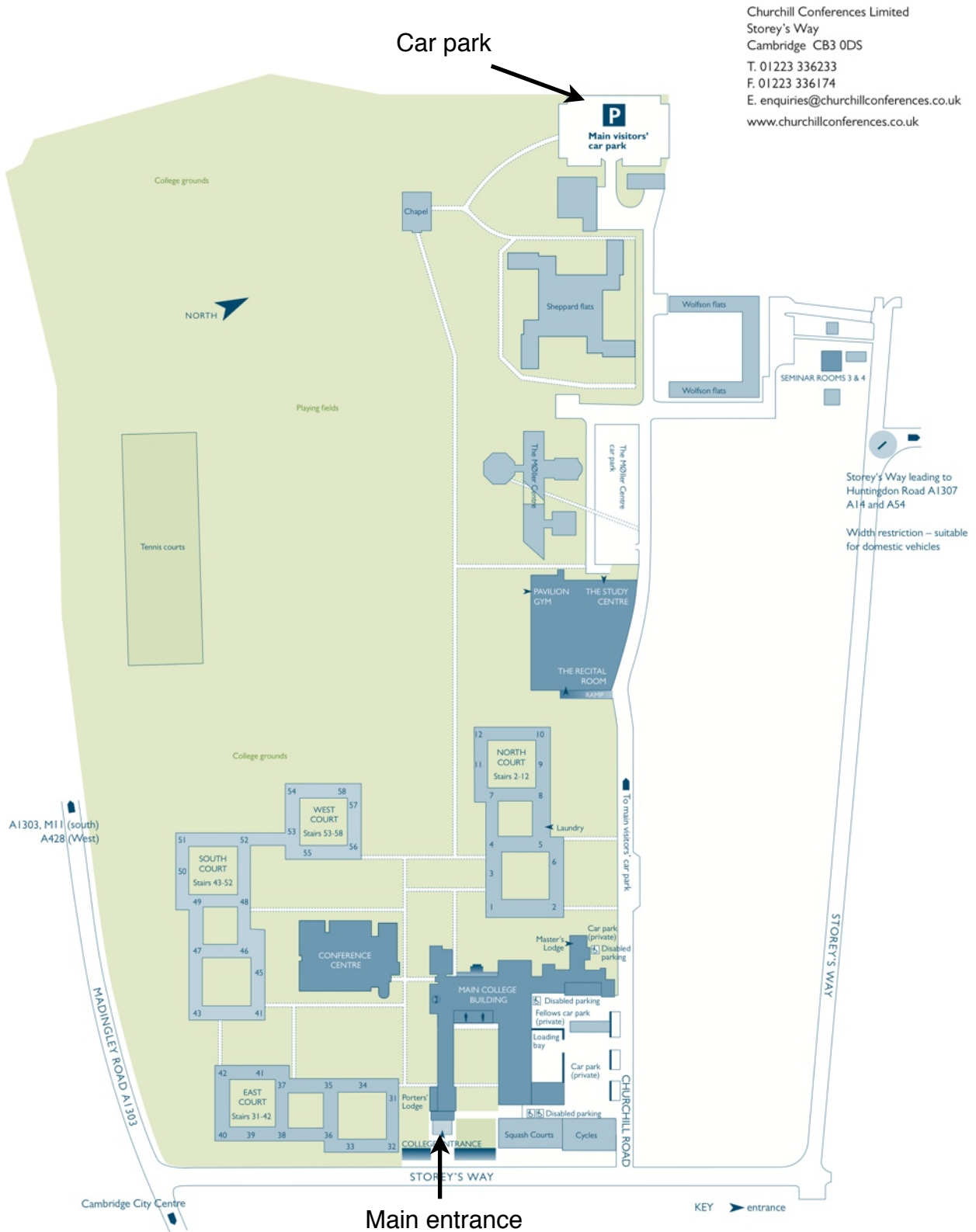

Churchill Conferences Limited
 Storey's Way
 Cambridge CB3 0DS
 T. 01223 336233
 F. 01223 336174
 E. enquiries@churchillconferences.co.uk
 www.churchillconferences.co.uk

Car park

Storey's Way leading to
 Huntingdon Road A1307
 A14 and A54
 Width restriction – suitable
 for domestic vehicles

Main entrance

KEY ➤ entrance

Ground floor

Concourse Cockcroft Room Seminar Room 2 Bar Loading bay Porters' Lodge



Conference centre
 Wolfson Hall Jock Colville Hall Bevin Room Wolfson Hall Foyer Conference Organiser's Office Seminar Room

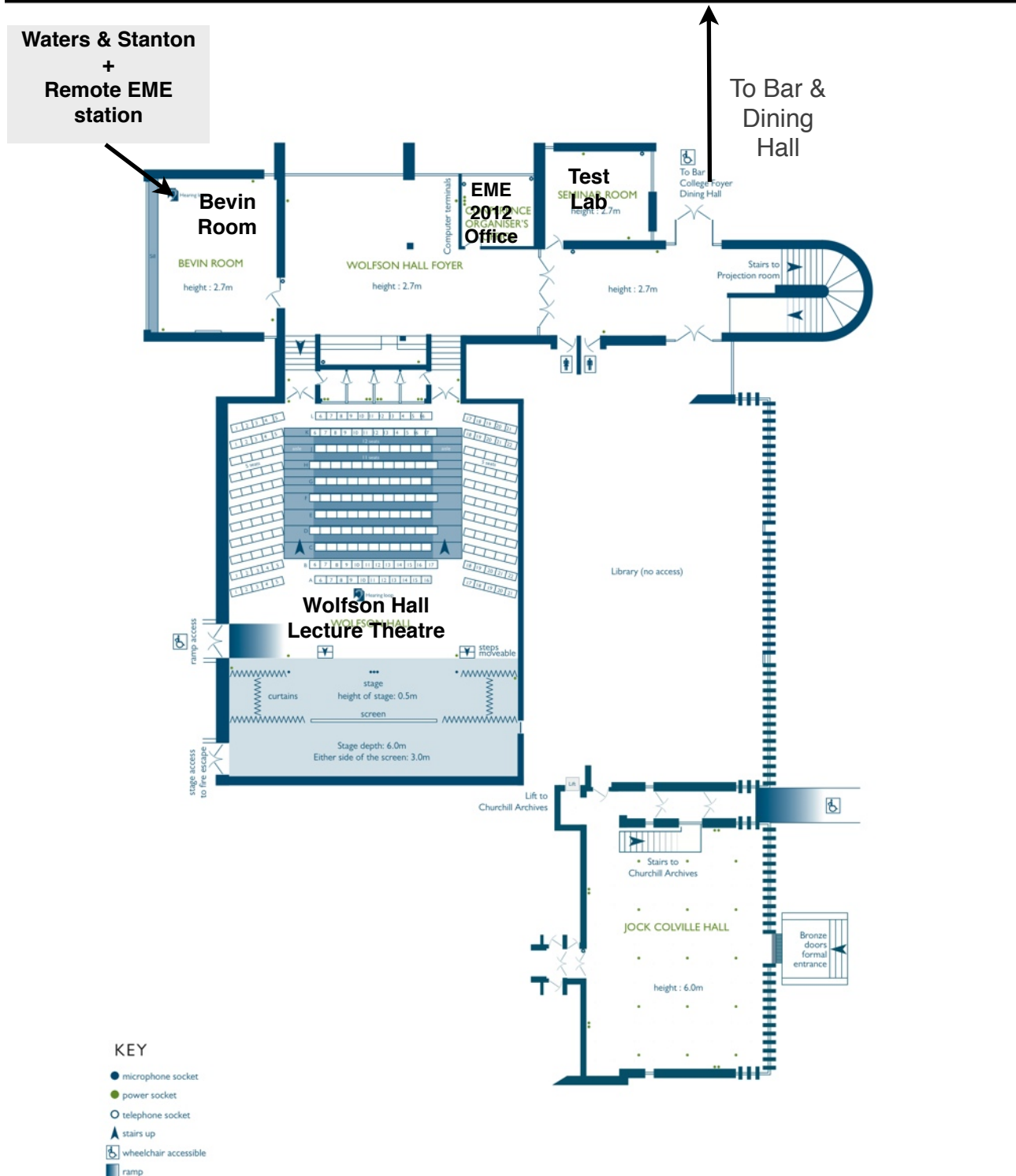

The Organisers



Graham Murchie G4FSG
Chairman of the Organising Committee



Brian Coleman G4NNS
Publicity & Pricing



Peter Blair G3LTF
Technical adviser



Dave Powis G4HUP
Treasurer



Doug Parker G4DZU
Booking



Ian White GM3SEK
Proceedings



John Worsnop G4BAO
Chairman, UK Microwave Group,
Partners' Programme



Sam Jewell G4DDK
Presentation Programme



Martin Richmond-Hardy G8BHC
Web site & bookings database



Murray Niman G6JYB
RSGB Microwave Manager
Conference server



John Quarmby G3XDY
Test Lab

The Reception Team

We are delighted to have the assistance of members of [Camb-Hams](#)

Steve Thomas	M1ACB	East Anglia Deputy Regional Manager, RSGB
Martin Atherton	G3ZAY	
Rob Chipperfield	M0VFC	
Dominic Smith	M0BLF	
Linda Wilkin	G0TPX	

Check-in

All overseas (non UK) visitors will have to fill in a form at the Porters Lodge.

Please check-in at the Reception desk and you will be provided with a bag containing:-

Name Badge (one per person).

Please wear this while you are on site – for security reasons and to obtain meals & refreshments, where booked!

A copy of the Proceedings for each delegate

Any polo shirts you may have ordered.

A welcome letter from Graham Murchie

A printed copy of this booklet

Raffle tickets (where pre-ordered)

Ethernet cable (residential delegates only)

How early can I check in? How late can I check out?

Accommodation booked at the College will not be available for occupancy earlier than 14.00 hours on the day of arrival.

Bedrooms should be vacated by 10.00 on the morning of departure. Please return your keys to the Porters' Lodge. There will be a replacement charge for any non-returned keys. The Porters can also advise on storage of luggage.

Breakfast and other meals

For those staying at Churchill College breakfast is served in the Dining Hall from 07.30 until 09.30.

For those staying at The Møller Centre breakfast is served from 07.15.

For guests who have not booked meals, lunch and dinner may be taken in the Hall, which operates a cash cafeteria-style service during the following times:

Lunch: 12.30 until 13.30

Dinner: 18.15 until 19.00

Please note: It's "pay as you go" with cash in the college.

The centre is not a hotel so it is NOT possible to set up an account and pay your bar and restaurant bill by credit card at the end of the conference.

Cash machine

The nearest cash machine (ATM) is 10 minutes walk away. Please ask the Porters or at reception for directions.

IT and Electrics

Mains supply

In the UK we have 240V 50Hz supply; you may require an adaptor for your existing plugs.

Internet Access

There is free WiFi access in the public areas. Each bed room has a RJ45 outlet and will require a CAT5 cable. NB there is a download limit of 500MB/day per MAC address so please don't plan on using iPlayer and the like for catching up on your favourite TV programme.

Some visitors' non-European phones may not roam/work on 3G as the frequency bands are different.

On-site server

Once you are connected to the college network an EME Conference file server will also be available. You can access this using your favourite file manager/app (fileshare path \\eme2012\public). You may use it to share photos. More details are available from EME2012 Reception.

Fire

Please read the evacuation information in your room. The fire alarms are tested once a week, on Wednesdays at 14.00. A fire extinguisher is located on the landing adjacent to the staircase.

Health and Safety

Your attention is drawn to the following

There are ornamental ponds in the grounds. Pathways, ramps and staircases are illuminated at night. Please do not attempt to take short cuts across unlit grounds where there may be tripping hazards.

Disabled visitors

Wheelchair access is available to all public areas. Please ask for guidance if you are unsure of the accessible routes. Induction loops for the hard of hearing are available in some rooms, including the Wolfson Hall.

Smoking

It is illegal in the UK to smoke in public places and in people's places of work.

Therefore smoking is not permitted in any College building including any bedroom area. If this condition is not adhered to guests may be asked to leave the College.

Insurance

Please take care of your personal belongings – neither the Conference Organisers nor Churchill College can be held responsible for any losses or damage.

Presentation schedule

Friday

08:30 Graham Murchie G4FSG Conference Opening by Chairman of the Organising Committee

Moderator: Doug McArthur VK3UM

08:35 Ian White GM3SEK Keynote
 08:55 Peter Blair G3LTF How good were the systems of the 60s and 70s?
 09:30 Al Ward W5LUA Progress at 24GHz and above
 10:05 BREAK

Moderator: Zdenek Samek OK1DFC

10:35 Alex Artieda HB9DRI The IQ+ dual channel receiver, a practical implementation against Faraday rotation
 11:10 Joe Taylor K1JT MAP65 software – an all-new version of MAP65 with many frequently-requested features
 11:45 Charlie Suckling G3WDG Application of GaN transistors to SSPAs for EME use
 12:15 LUNCH

Moderator: Michael Kholo DL1YMK

13:15 Ingolf Larsson SM6FHZ
 Zdenek Samek OK1DFC Unexplored areas of 432MHz feeds
 14:00 Hannes Fasching OE5JFL Gaining extra dB from a small dish
 14:35 Dave Powis G4HUP Stresses on ropes and cables when raising and lowering towers
 15:05 BREAK

Moderator: Ingolf Larsson SM6FHZ

15:35 John Worsnop G4BAO Modifying 1960MHz SSPAs for 13cm
 16:05 Manfred Ploetz DL7YC For a few dollars - 40 more Watts at 3400 MHz
 16:35 Dave Robinson WW2R/G4FRE Control and monitoring of EME solidstate amplifiers

Moderator: Ian White GM3SEK

17:05 Open session
 17:30 Flea market : Chat : Bar
 Evening Dinner

Speaker : Howard Long G6LVB

Friday – Multimedia presentations

10:05 Paul Marsh M0EYT Amateur deep space reception-equipment and techniques
 13:15 Mike Watanabe JH1KRC A brass bar and rotation mechanism for MAB25 encoders
 15:05 Doug Millar K6JEY Comparing calorimetric RF power measurements at 1.2GHz with a Variety of Meters

Saturday

08:30 Graham Murchie G4FSG Welcome to the second day

Moderator: Jan van Muijlwijk PA3FXB

08:35 Ian White GM3SEK
Dave Stockton GM4ZNX Noise Figure Measurements – A Reality Check

09:10 Doug McArthur VK3UM Inaccuracies that will lead to a deficiency in your EME systems performance or Why the other guy does better than you!

09:45 Charlie Suckling G3WDG A novel 13cm receive converter

10:20 BREAK

Moderator: Mike Watanabe JH1KRC

10:50 Jan Van Muilwijk PA3FXB PI9CAM – History and restoration

11:25 Daniela de Paulis Visual Moonbounce – moonbouncing images as a new application of Moonbounce

12:00 LUNCH

Moderator: Franck Tonna F5SE

13:00 Dr David Morgan Detection of Extra Galactic Radio Source Virgo A

13:35 Al Katz K2UYH Simple and low cost solutions for high gain on 70 and 23cm using offset dishes

14:10 Paul Wade W1GHZ Horns and septum feeds – Construction tolerances and sensitivity

14:45 BREAK

Moderator: Al Ward W5LUA

15:15 Murray Niman G6JYB Frequencies for EME - Past Present & Future. Including Forum discussion.

Gudmund Wannberg SM2BYA The 2.3-2.45 GHz spectrum situation and current threats in Sweden.

16:00 Eddy Jespers ON7UN
Walter Crauwels ON4BCB ON0EME:1296MHz moon beacon

16:30 Zdenek Samek OK1DFC EME DXpedition IS0/OK5EME

Moderators: Sam Jewell G4DDK and Dave Powis G4HUP

17:00 Conference close

17:30 Wrap up: Next Conference bids, Group photos, AOB

Evening Conference Dinner Speaker: Prof. Antony Hewish FRS

Saturday – Multimedia presentations

10:20 Ingo Gaspard DF1VH Solid state broadband un-cooled noise generator with noise temperature below room temperature

13:35 Sam Jewell G4DDK VLNA Update - latest developments for the VLNA Preamp

14:45 Gaëtan Horlin ON4KHG What is Ground Gain and what to expect from it

Test lab

Location

En route to the Wolfson Hall lecture theatre, before the double doors next to the EME2012 office

Equipment

Sam G4DDK and John G3XDY will have:

**HP8970A NF measuring set in conjunction with a HP346A 6dB ENR Noise Source
HP346C for 24GHz. TCold being read and set manually.**

With the use of external converters, this will provide NF measurement from 50MHz to 24GHz.

Dominique HB9BBD will be using his

Agilent 8975A

**Agilent N4000A 6dB ENR noise source with integral temperature compensation
for TCold.**

This is a standalone item that covers 10MHz – 18GHz

Graham G4FSG has provided:

**Agilent 6GHz scalar network analyser to measure return loss and to sweep
filters.**

Schedule for the visits programme

Thursday 16th – All day Visit to Bletchley Park

This includes lunch and Colossus and Tunny visit.

- 08:30 Assemble Churchill College by Porter's Lodge**
- 09:00 Depart Churchill**
- 10:30 Arrive Bletchley Park and proceed from Coach park to reception**
- 16:00 Depart Bletchley Park**
- 17:30 Arrive back at Churchill**

Delegates not going to Bletchley are asked to make their own arrangements for the day.
Delegates should make their own dining arrangements.

Friday 17th – For Partners: Self-guided, free day to look round Cambridge

Churchill College is easy walking distance (approx 20 minutes) from Cambridge city centre.

Taxis can be booked from the Porter's lodge

Buses can be taken from Madingley Road (Storeys Way or Bulstrode Gardens) in to Cambridge.

Maps will be available.

- 1930 Dinner at Churchill**

Saturday 18th – For Partners: Visit to Saffron Walden and Audley End House

Saffron Walden

- 09:30 Coach departs Churchill for Saffron Walden**
- 10:00 Coach drops off at [The Common, Saffron Walden](#) where partners will be split in to three groups each group with a tour guide.**

[Saffron Walden Tourist Office](#)

1 Market Place

Saffron Walden

Essex CB10 1HR

Tel: 01799 524002.

Should anyone get separated from the Tour guide, the coach will be parked at the Swan Meadow [car park, New Pond Lane](#) until departure for Audley End at The Common.

- 12:30 Lunch in Saffron Walden (self arranged)**

Audley End House

- 13:30 Coach departs from The Common, Saffron Walden for [Audley End House](#)**
- 13:45 arrive Audley End**

There is no formal guided tour, but the coach will be met by a guide, and partners given a short introduction to the house and gardens. If the weather is inclement, the guide will give the introduction on the coach. Partners will then be then free to visit all the attractions unaccompanied.

- 16:30 Coach departs from the car park for return to Churchill**

Delegate list by callsign

Callsign	FirstName	SurName	PartnerFullName	Partner Callsign
	Glyn	Haslam		
	Prof. Antony	Hewish		
	David	Morgan	Mrs Morgan	
	Daniela	de Paulis		
	Val	Gawthorpe		
4X1DG	David	Greenberg	Shosh Greenberg	
AA7FV	Darrel	Emerson		
CT1HZE	Joachim (Joe)	Kraft		
DF1VH	Ingo	Gaspard		
DF7TT	Juergen	Oehler		
DG0AG	Dr Siegmar	Hecht	Cornelia Hecht	
DJ3FI	Hubert	Tiedmann		
DJ3QD	Wolfgang	Arnold		
DJ8FR	Juergen	Friedrich		
DK3NG	Joachim	Groeger	Rie Groeger	
DK8ZJ	Martin	Wilschke	Anke Wilschke	
DL1HYZ	Ulrich	Halusa		
DL1YMK	Michael	Khola	Monika Khola	
DL2HWA	Dietmar	Lindner		
DL6SH	Slawek Miroslav	Schulz	Silvia Schulz	
DL6ZAU	Gerd	Volkman		
DL7APV	Bernd	Wilde	Astrid Lachner	
DL7HR	Berndt	Helmke	Ingrid Helmke	
DL7UDA	Dietmar	Rummel		
DL7YC	Manfred	Ploetz		
DL9KR	Jan	Bruinier		
DM2AYO	Sid	Blechs Schmidt		
DM2DTH	Klaus	Hantelmann	Karin Hantelmann	
EA1DDO	Maximo	Martin		
EI2FG	John	Hearne		
EI7FJ	William	McLoughlin		
F1PYR	André	Esnault		
F2CT	Guy	Gervais	Corine Guillard	
F2TU	Philippe	Pierrat	Marie Thérèse Pierrat	
F5AYE	Jean Paul	Piller	Hanina Piller	
F5JWF	Philippe	Borghini	Patricia Borghini	
F5SE	Franck	Tonna	Lioudmila Tonna	
F6AJW	Jacques	Gruson		
F6AYK	Elyane	Daniel		
F6DLA	William	Benson	Jacqueline Benson	
G0BBL	Jan	Verduyn		
G0HAT	John	Bales		
G0KSC	Justin	Johnson	Collette Johnson	
G0MJW	Mike	Willis		
G0MRF	David	Bowman		
G0TPX	Linda	Wilkin		
G0VIH	Ian	Broadwell		
G0VQH	Jenny	Bailey		
G0XAR	Steve	Farthing		

Callsign	FirstName	SurName	PartnerFullName	Partner Callsign
G3AAF	Kevin	Avery		
G3LGR	Michael	Hooles		
G3LTF	Peter	Blair	Margaret Blair	
G3LYP	Michael	Scott		
G3NLZ	Ken	Lunt		
G3NYK	Alan	Melia		
G3OFE	Vaughan	Cherry	Jenny Cherry	
G3PYB	Peter	Blakeborough		
G3RUH	James	Miller		
G3VZV	Graham	Shirville		
G3WDG	Charlie	Suckling		
G3WRT	Ian	Dilworth		
G3XDY	John	Quarmby		
G3XJE	Peter	Duffet-Smith		
G3ZAY	Martin	Atherton		
G3ZIG	Roy	Reed		
G4ALH	Rob	Scaife		
G4BAO	John	Worsnop	Vicki Worsnop	
G4CCH	Howard	Ling	Pauline Ling	
G4CDY	Terry	Giles		
G4CSD	Paul	Hyde		
G4DDK	Sam	Jewell	Shirley Jewell	
G4DKX	Ned	Cartwright		
G4DZU	Doug	Parker	Jane Parker	
G4ERO	Colin	Leonard		
G4FSG	Graham	Murchie	Jenny Murchie	
G4HJW	Bernie	Wright		
G4HQX	Pete	Morys		
G4HSK	Steve	Glass		
G4HUP	Dave	Powis		
G4JNT	Andy	Talbot		
G4KGC	Petra	Suckling		
G4KLA	John	Nelson	Rosslyn Nelson	
G4KUX	Nick	Peckett	Dorothy Peckett	
G4LBH	Richard	Giles		
G4LDR	Neil	Underwood		
G4LOH	Tim	Fern	Anita Fern	
G4MVU	David	Crowe	Lena Crowe	
G4NNS	Brian	Coleman		
G4NRG	Roger	Greengrass		
G4RGK	Dave	Dibley	Carole Dibley	
G4SUM	Keith	Summerhill		
G4SWX	John	Regnault		
G4YTL	David	Hilton-Jones		
G6JYB	Murray	Niman		
G6LVB	Howard	Long		
G6PHH	Philip	Dickens		
G7SKR	Dave	Tarbatt		
G8AFC	Paul	Entwistle		
G8BHC	Martin	Richmond-Hardy		
G8CZP	Vince	Maund		
G8DOH	Alwyn	Seeds		
G8DQX	Robin	Gape		

Callsign	FirstName	SurName	PartnerFullName	Partner Callsign
G8FEK	Martyn	Gawthorpe	Val Gawthorpe	
G8GTZ	Noel	Matthews		
GI1CET	Jim	Barr		
GM3SEK	Ian	White	Nadine White	MM0WNW
GM4JJJ	David	Anderson	Pat Anderson	
GM4PMK	Roger	Blackwell	Sarah Blackwell	
GM4ZNX	David	Stockton		
GM6VXB	Martin	Andrew		
GM8ZKU	Simon	Hawley		
GW0UDJ	Derek	Jones	Alison Morris-Jones	
HB9BBD	Dominique	Fæsler	Susan Fæsler	
HB9DRI	Alex	Artieda		
HS1IWX	Amnat	Chulajata	Supanee Chulajata	E22FQO
I0NAA	Mario Armando	Natali	Marina Menna	
I1NDP	Nando	Pellegrini		
IK6EIW	Stefano	Magnarello	Alessandra Magnarello	
JA4BLC	Yoshiro	Mataka	Tsuneko Mataka	JH4GJY
JE1OYE	Takuro	Suzuki		
JF3HUC	Yoshitaka	Takahashi		
JH1KRC	Mike (Michiaki)	Watanabe	Miwako Watanabe	JP1LAB
JH3BJN	Sumio	Nakane		
JH5FOQ	Hidenori	Hayashi		
JH6RTO	Seiji	Fukushima		
K1DS	Rick	Rosen	Jani Rosen	
K1JT	Joe	Taylor	Marietta Taylor	
K2TXB	Russel	Pillsbury	Barbara Pillsbury	
K2UYH	Al	Katz	Sally Katz	
K5GW	Gerald	Williamson		
K6JEY	Douglas	Millar	Helen Mahoney	
LU1CGB	Adrian	Sinclair		
M0BLF	Dominic	Smith		
M0EYT	Paul	Marsh		
M0VFC	Rob	Chipperfield		
M1ACB	Steve	Thomas		
M1BXF	Gavin	Nesbitt		
M3YPZ	Alex	Popple		
MW0CBC	Denis	Jackson		
N2KBO	Douglas	Green		
N4PZ	Stephen	Gross		
NV3V	Martin	Cadirola		
OE3FVU	Franz	van Velzen	Andrea Hovenier	
OE5JFL	Hannes	Fasching		
OH1LRY	Janne	Peltonen		
OH3MCK	Petri	Kotilainen		
OK1CA	Frantisek	Strihavka		
OK1CS	Emil	Slaby		
OK1DAK	Vladimir	Masek		
OK1DAI	Antonin	Jelinek		
OK1DFC	Zdenek	Samek		
OK1TEH	Matej	Petrzilka		
OK1VPZ	Vladimir	Petrzilka		

Callsign	FirstName	SurName	PartnerFullName	Partner Callsign
ON3SWY	Gert	Verswyvel		
ON4BCB	Walter	Crauwels		
ON4CO	Jan	Jacops		
ON4KHG	Gaëtan	Horlin		
OK4MT	Milos	Tygl		
ON5GN	Pierre	Vanhoucke		
ON5RR	Marc	Kleyn	Patricia De Leebeeck	
ON5TA	Eric	Van Offelen		
ON7UN	Eddy	Jespers		
OZ1FF	Kjeld Bülow	Thomsen	Hilda Bang	
OZ1RH	Palle	Preben-Hansen		
PA0EHG	Hans	van Alphen		
PA1IVO	Ivo	Klinkert		
PA2DW	Dick	Harms	Beatrijs van Pelt	
PA3DZL	Jac	de Bruijn	Iris de Bruijn	
PA3FPQ	Johan	Swienink		
PA3FXB	Jan	van Muijlwijk	Marjan Pierhagen	
PA7JB	John	Lambo		
PE1ITR	Rob	Hardenberg		
PE1LWT	Jurgen	vd Glind		
PY2BS	Bruce	Halasz	Dagima Halasz	
SM2BYA	Gudmund	Wannberg	Asta Pellinen.Wannberg	
SM3JQU	Per	Sjolander		
SM3YKR	Erik	Sjolander		
SM4IVE	Lars	Pettersson		
SM5BSZ	Leif	Asbrink		
SM6CKU	Bengt	Jockert	Barbro Jockert	
SM6FHZ	Ingolf	Larsson	Ingela Kjellen	
SM7FWZ	Ronny	Lembke		
SM7GVF	Kjell	Jarl		
UT3LL	Valeriy	Loshakov		
VE2EUT	Jean G	Langevin		
VK2FLR	Michael	Farrell		
VK2KU	Guy	Fletcher	Catherine Fletcher	
VK3UM	Doug	McArthur	Bev McArthur	
VK4CDI	Phil	Moat	Sandra Moat	
W1GHZ	Paul	Wade	Elizabeth Wade	N1SAI
W2CNS	Robert	Nezelek		
W5LUA	Al	Ward	Emily Ward	
W7CJO	James	Vogler		
W7CJO	James	Vogler		
WA3QPX	Paul	Domanski	B Judy Domanski	
WA5JAT	James	Hudson	Connie Hudson	
WA5VJB	Kent	Britain		
WA8RJF	Tony	Emanuele	Diane Emanuele	
WB0DBS	Steve	Krull		
WB2BYP	John	Stevens	Gloria Butterworth	
WB4DTD	Ivan	Venuchekov	Mrs Venuchekov	
WW2R/G4FRE	David	Robinson	Meg Robinson	M0FRE

Delegate list by surname

Callsign	FirstName	SurName	PartnerFullName	Partner Callsign
GM4JJJ	David	Anderson	Pat Anderson	
GM6VXB	Martin	Andrew		
DJ3QD	Wolfgang	Arnold		
HB9DRI	Alex	Artieda		
SM5BSZ	Leif	Asbrink		
G3ZAY	Martin	Atherton		
G3AAF	Kevin	Avery		
G0VQH	Jenny	Bailey		
G0HAT	John	Bales		
GI1CET	Jim	Barr		
F6DLA	William	Benson	Jacqueline Benson	
GM4PMK	Roger	Blackwell	Sarah Blackwell	
G3LTF	Peter	Blair	Margaret Blair	
G3PYB	Peter	Blakeborough		
DM2AYO	Sid	Blechs Schmidt		
F5JWF	Philippe	Borghini	Patricia Borghini	
G0MRF	David	Bowman		
WA5VJB	Kent	Britain		
G0VIH	Ian	Broadwell		
DL9KR	Jan	Bruinier		
NV3V	Martin	Cadirola		
G4DKX	Ned	Cartwright		
G3OFE	Vaughan	Cherry	Jenny Cherry	
M0VFC	Rob	Chipperfield		
HS1IWX	Amnat	Chulajata	Supanee Chulajata	E22FQO
G4NNS	Brian	Coleman		
ON4BCB	Walter	Crauwels		
G4MVU	David	Crowe	Lena Crowe	
F6AYK	Elyane	Daniel		
PA3DZL	Jac	de Bruijn	Iris de Bruijn	
-	Daniela	de Paulis		
G4RGK	Dave	Dibley	Carole Dibley	
G6PHH	Philip	Dickens		
G3WRT	Ian	Dilworth		
WA3QPX	Paul	Domanski	B Judy Domanski	
G3XJE	Peter	Duffet-Smith		
WA8RJF	Tony	Emanuele	Diane Emanuele	
AA7FV	Darrel	Emerson		
G8AFC	Paul	Entwistle		
F1PYR	André	Esnault		
HB9BBD	Dominique	Fæsler	Susan Fæsler	
VK2FLR	Michael	Farrell		
G0XAR	Steve	Farthing		
OE5JFL	Hannes	Fasching		
G4LOH	Tim	Fern	Anita Fern	
VK2KU	Guy	Fletcher	Catherine Fletcher	
DJ8FR	Juergen	Friedrich		
JH6RTO	Seiji	Fukushima		

Callsign	FirstName	SurName	PartnerFullName	Partner Callsign
G8DQX	Robin	Gape		
DF1VH	Ingo	Gaspard		
	Val	Gawthorpe		
G8FEK	Martyn	Gawthorpe		
F2CT	Guy	Gervais	Corine Guillard	
G4CDY	Terry	Giles		
G4LBH	Richard	Giles		
G4HSK	Steve	Glass		
N2KBO	Douglas	Green		
4X1DG	David	Greenberg	Shosh Greenberg	
G4NRG	Roger	Greengrass		
DK3NG	Joachim	Groeger	Rie Groeger	
N4PZ	Stephen	Gross		
F6AJW	Jacques	Gruson		
PY2BS	Bruce	Halasz	Dagima Halasz	
DL1HYZ	Ulrich	Halusa		
DM2DTH	Klaus	Hantelmann	Karin Hantelmann	
PE1ITR	Rob	Hardenberg		
PA2DW	Dick	Harms	Beatrijs van Pelt	
	Glyn	Haslam		
GM8ZKU	Simon	Hawley		
JH5FOQ	Hidenori	Hayashi		
EI2FG	John	Hearne		
DG0AG	Dr Siegmar	Hecht	Cornelia Hecht	
DL7HR	Berndt	Helmke	Ingrid Helmke	
	Prof. Antony	Hewish		
G4YTL	David	Hilton-Jones		
G3LGR	Michael	Hooles		
ON4KHG	Gaëtan	Horlin		
WA5JAT	James	Hudson	Connie Hudson	
G4CSD	Paul	Hyde		
MW0CBC	Denis	Jackson		
ON4CO	Jan	Jacops		
SM7GVF	Kjell	Jarl		
OK1DAI	Antonin	Jelinek		
ON7UN	Eddy	Jespers		
G4DDK	Sam	Jewell	Shirley Jewell	
SM6CKU	Bengt	Jockert	Barbro Jockert	
G0KSC	Justin	Johnson	Collette Johnson	
GW0UDJ	Derek	Jones	Alison Morris-Jones	
K2UYH	Al	Katz	Sally Katz	
DL1YMK	Michael	Khola	Monika Khola	
ON5RR	Marc	Kleyn	Patricia De Leebeeck	
PA1IVO	Ivo	Klinkert		
OH3MCK	Petri	Kotilainen		
CT1HZE	Joachim (Joe)	Kraft		
WB0DBS	Steve	Krull		
PA7JB	John	Lambo		
VE2EUT	Jean G	Langevin		
SM6FHZ	Ingolf	Larsson	Ingela Kjellen	
SM7FWZ	Ronny	Lembke		
G4ERO	Colin	Leonard		

Callsign	FirstName	SurName	PartnerFullName	Partner Callsign
DL2HWA	Dietmar	Lindner		
G4CCH	Howard	Ling	Pauline Ling	
G6LVB	Howard	Long		
UT3LL	Valeriy	Loshakov		
G3NLZ	Ken	Lunt		
IK6EIW	Stefano	Magnarello	Alessandra Magnarello	
M0EYT	Paul	Marsh		
EA1DDO	Maximo	Martin		
OK1DAK	Vladimir	Masek		
JA4BLC	Yoshiro	Mataka	Tsuneko Mataka	JH4GJY
G8GTZ	Noel	Matthews		
G8CZP	Vince	Maund		
VK3UM	Doug	McArthur	Bev McArthur	
EI7FJ	William	McLoughlin		
G3NYK	Alan	Melia		
K6JEY	Douglas	Millar	Helen Mahoney	
G3RUH	James	Miller		
VK4CDI	Phil	Moat	Sandra Moat	
	David	Morgan	Mrs Morgan	
G4HQX	Pete	Morys		
G4FSG	Graham	Murchie	Jenny Murchie	
JH3BJN	Sumio	Nakane		
I0NAA	Mario Armando	Natali	Marina Menna	
G4KLA	John	Nelson	Roslyn Nelson	
M1BXF	Gavin	Nesbitt		
W2CNS	Robert	Nezelek		
G6JYB	Murray	Niman		
DF7TT	Juergen	Oehler		
G4DZU	Doug	Parker	Jane Parker	
G4KUX	Nick	Peckett	Dorothy Peckett	
I1NDP	Nando	Pellegrini		
OH1LRY	Janne	Peltonen		
OK1TEH	Matej	Petrzilka		
OK1VPZ	Vladimir	Petrzilka		
SM4IVE	Lars	Petersson		
F2TU	Philippe	Pierrat	Marie Thérèse Pierrat	
F5AYE	Jean Paul	Piller	Hanina Piller	
K2TXB	Russel	Pillsbury	Barbara Pillsbury	
DL7YC	Manfred	Ploetz		
M3YPZ	Alex	Popple		
G4HUP	Dave	Powis		
OZ1RH	Palle	Preben-Hansen		
G3XDY	John	Quarmby		
G3ZIG	Roy	Reed		
G4SWX	John	Regnault		
G8BHC	Martin	Richmond-Hardy		
WW2R/G4FRE	David	Robinson	Meg Robinson	M0FRE
K1DS	Rick	Rosen	Jani Rosen	
DL7UDA	Dietmar	Rummel		
OK1DFC	Zdenek	Samek		
G4ALH	Rob	Scaife		
DL6SH	Slawek Miroslav	Schulz	Silvia Schulz	
G3LYP	Michael	Scott		

Callsign	FirstName	SurName	PartnerFullName	Partner Callsign
G8DOH	Alwyn	Seeds		
G3VZV	Graham	Shirville		
LU1CGB	Adrian	Sinclair		
SM3JQU	Per	Sjolander		
SM3YKR	Erik	Sjolander		
OK1CS	Emil	Slaby		
M0BLF	Dominic	Smith		
WB2BYP	John	Stevens	Gloria Butterworth	
GM4ZNX	David	Stockton		
OK1CA	Frantisek	Strihavka		
G3WDG	Charlie	Suckling		
G4KGC	Petra	Suckling		
G4SUM	Keith	Summerhill		
JE1OYE	Takuro	Suzuki		
PA3FPQ	Johan	Swienink		
JF3HUC	Yoshitaka	Takahashi		
G4JNT	Andy	Talbot		
G7SKR	Dave	Tarbatt		
K1JT	Joe	Taylor	Marietta Taylor	
M1ACB	Steve	Thomas		
OZ1FF	Kjeld Bülow	Thomsen	Hilda Bang	
DJ3FI	Hubert	Tiedmann		
F5SE	Franck	Tonna	Lioudmila Tonna	
OK4MT	Milos	Tygl		
G4LDR	Neil	Underwood		
PA0EHG	Hans	van Alphen		
PE1LWT	Jurgen	vd Glind		
PA3FXB	Jan	van Muijlwijk	Marjan Pierhagen	
ON5TA	Eric	Van Offelen		
OE3FVU	Franz	van Velzen	Andrea Hovenier	
ON5GN	Pierre	Vanhoucke		
WB4DTD	Ivan	Venuchekov	Mrs Venuchekov	
G0BBL	Jan	Verduyn		
ON3SWY	Gert	Verswyvel		
W7CJO	James	Vogler		
W7CJO	James	Vogler		
DL6ZAU	Gerd	Volkmann		
W1GHZ	Paul	Wade	Elizabeth Wade	N1SAI
SM2BYA	Gudmund	Wannberg	Asta Pellinen.Wannberg	
W5LUA	Al	Ward	Emily Ward	
JH1KRC	Mike (Michiaki)	Watanabe	Miwako Watanabe	JP1LAB
GM3SEK	Ian	White	Nadine White	MM0WNW
DL7APV	Bernd	Wilde	Astrid Lachner	
G0TPX	Linda	Wilkin		
K5GW	Gerald	Williamson		
G0MJW	Mike	Willis		
DK8ZJ	Martin	Wilschke	Anke Wilschke	
G4BAO	John	Worsnop	Vicki Worsnop	
G4HJW	Bernie	Wright		